

24385 **Leaf Spring** **Installation Instructions**



Thank you for your purchase of this Hotchkis Performance product. Your Leaf Spring set was designed with the performance and durability you've come to expect from Hotchkis Performance.

Note: Please read the entire installation instructions before starting. Having the right tools will ensure a smooth install process.

LEAF SPRING INSTALLATION

- 1. Using a jack or lift, raise the rear of the car slightly to relieve the springs of stress.**

Note: Do not lift the car completely off the ground.

2. Remove the lower shock mount plate nuts.

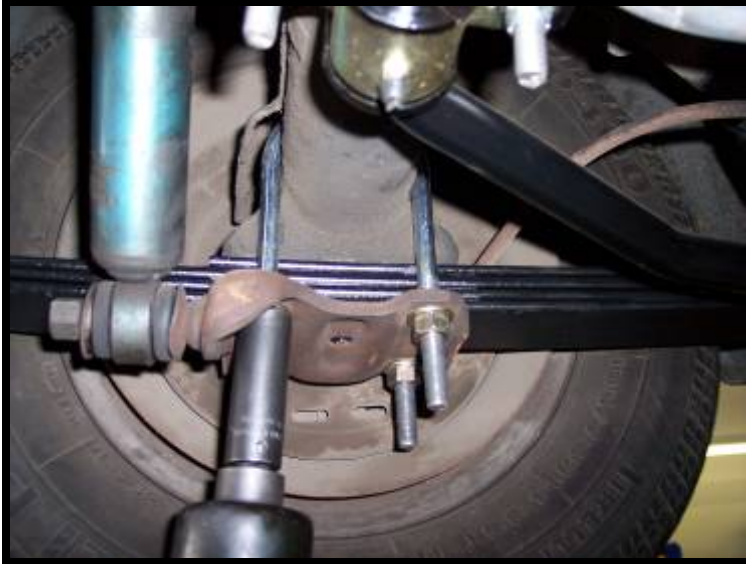

3. Loosen the lower shock nut allowing the plate to pivot.



4. Now remove the lower shock mount plate from the U-bolts.



5. Loosen the two rear bracket nuts.
NOTE: Do not completely remove these nuts yet.



6. Support the spring with a stand and remove the 4 nuts on the front bracket.



7. Now remove the lower nut on the rear bracket and slide the leaf spring off the bracket bolt.

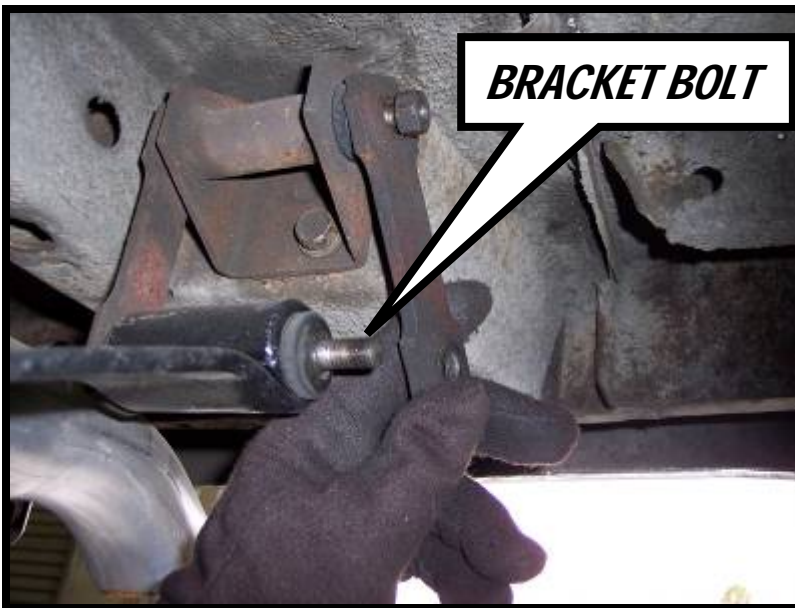

8. Install the new Hotchkis front bracket and bushings.

NOTE: The front brackets have a top and bottom. The two holes that are closer together go on top.

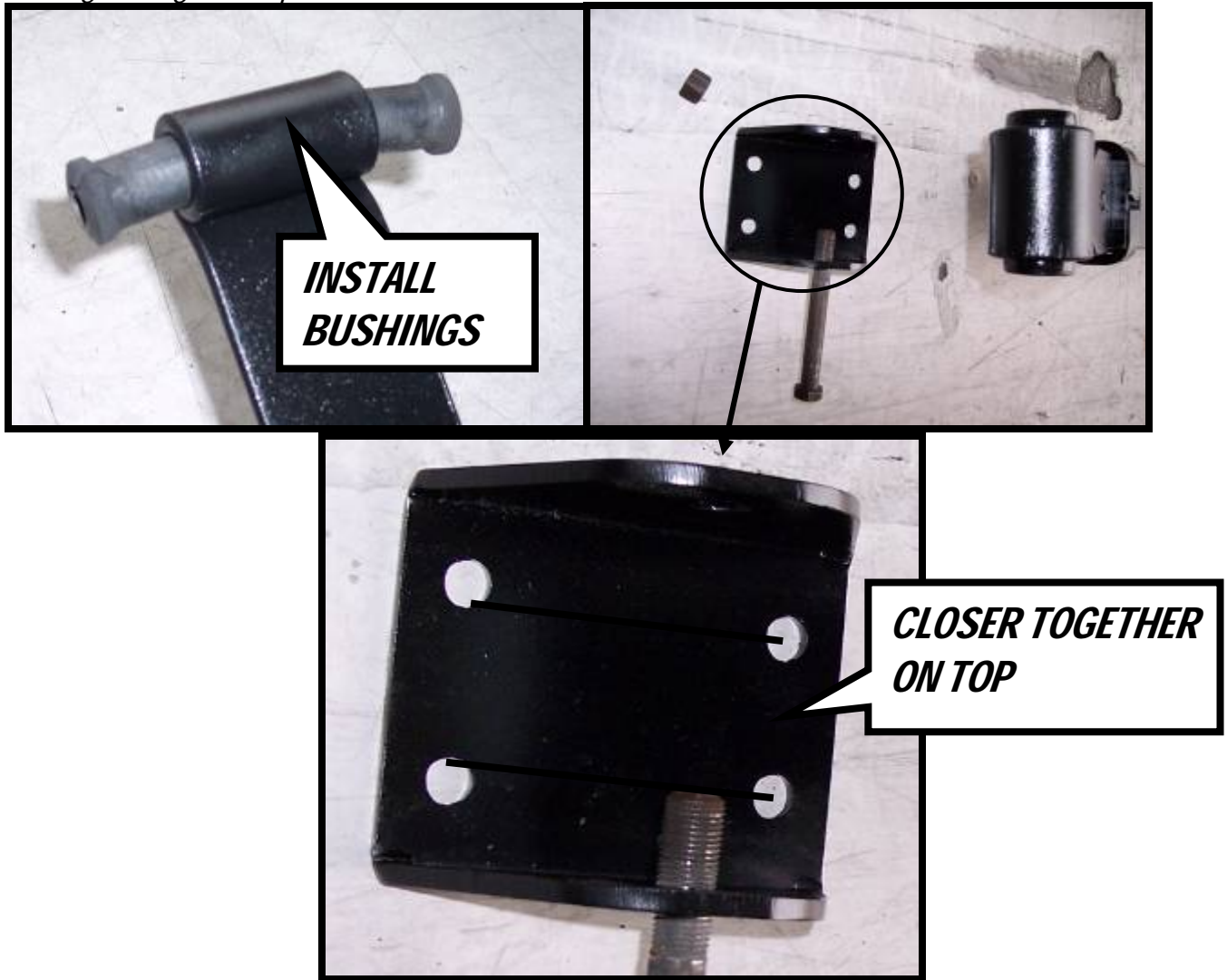

9. Install the new Leaf Spring by following these same steps in reverse order.

NOTE: When tightening the lower shock mount bracket nuts, be sure the peg on the leaf spring lines up inside the hole on the axle mount.

